

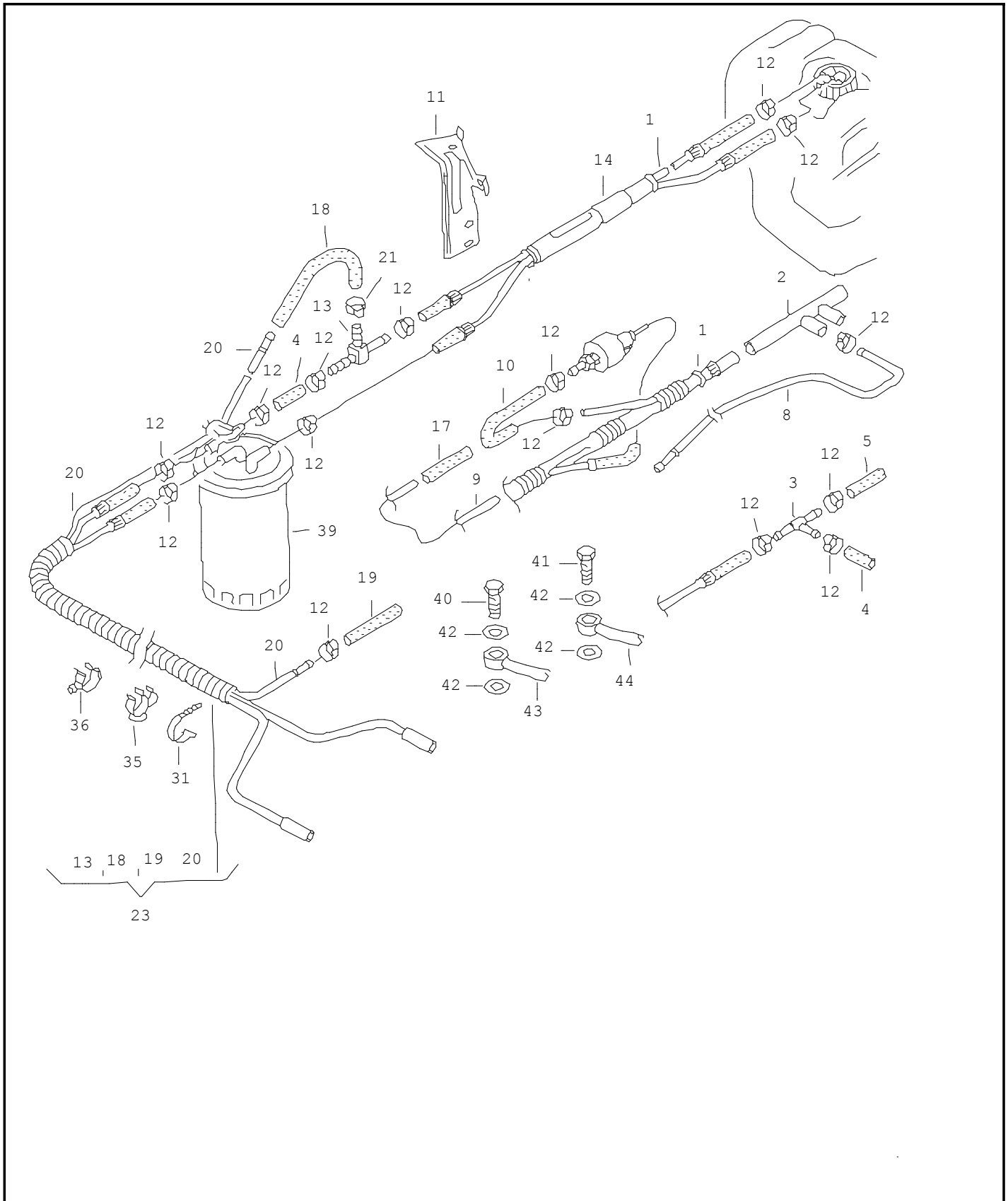

ETKA



Model	Year	MG	SG	Illustration	Restrictions	Update		
TR	02	2	01	201-25		436	9:48	24.10.2006





ETKA



Model	Year	MG	SG	Illustration	Restrictions	Update	9:48	24.10.2006
TR	02	2	01	201-25		436		

Pos	Part Number	Name	Remarks	Qty	Model
		fuel line			diesel eng.
1	701 201 080 BE	1 set of fuel pipes feed- and return pipe in pairs		1	
(1)	701 201 080 BG	1 set of fuel pipes feed- and return pipe in pairs for vehicles with auxiliary heater auxiliary heater for coolant circuit	D3W	1	PR-7VE, 9M5
(1)	701 201 080 BH	1 set of fuel pipes feed- and return pipe in pairs for vehicles with auxillary heater additional heater	D3W	1	PR-7VG, 7VH
2	701 201 943	t-piece for vehicles with auxillary heater for additional heater		1	
3	701 201 928 C	t-piece for vehicles with auxillary heater		1	
-	N 101 207 01	hose in coils of 5m 'order unit 5'	5,5X3	*	
4		shorten to:	50MM	2	
-	N 103 035 01	hose in coils of 5m 'order unit 5'	7X3	*	
5		shorten to:	75MM	1	
8	701 201 901 B	fuel line for vehicles with additional heater		1	
		use if required:	191 201 316	2	
9	701 201 901 K	fuel line for vehicles with	D3W	1	
(9)	701 201 901 M	fuel line for vehicles with auxiliary heater		1	
10	701 201 143	fuel hose for vehicles with auxiliary heater		1	
11	701 201 505 D	bracket for fuel filter F >> 70-2-061 613*		1	
(11)	7D0 201 505 E	bracket for fuel filter F 70-2-061 614>>*		1	



ETKA



Model	Year	MG	SG	Illustration	Restrictions	Update	9:48	24.10.2006
TR	02	2	01	201-25		436		

Pos	Part Number	Name	Remarks	Qty	Model
12	N 024 122 2	clip	9X11-15	X	
13	251 201 346	t-piece	6/4/6	1	
14	--- --- ---	no longer available		1	
-	059 130 329	hose in coils of 5m 'order unit 5'	3,5X1,9 -RME-	*	
17		shorten to:	100MM	1	
18		shorten to:	90MM	1	
19		shorten to:	130MM	1	
21	N 100 911 01	clip	7,5-9	X	
(23)	701 201 204 BG	fuel line assembly(assy)		1	ABL
(23)	701 201 204 AK	fuel line assembly(assy)		1	AJA
(23)	701 201 204 AL	fuel line assembly(assy) for vehicles with automatic for vehicles with air condit.		1	AJA
(23)	7D0 201 204	fuel line assembly(assy) for manual gearbox for vehicles with air condit.		1	ACV,AJT,AUF
(23)	7D0 201 204 C	fuel line assembly(assy) for vehicles with automatic		1	ACV
(23)	7D0 201 204 C	fuel line assembly(assy) F >> 70-X-200 000*		1	automatic: AUF; manual- gearbox: AJT,AHY
(23)	7D0 201 204 H	fuel line assembly(assy) F 70-Y-000 001>>*		1	automatic: AUF; manual- gearbox: AJT,AHY,AXG
31	N 906 661 01	cable tie	4,5X200	1	
35	701 201 369	bracket for fuel line		1	
36	357 820 755	bracket for hose	27/21	1	



ETKA



Model	Year	MG	SG	Illustration	Restrictions	Update	9:48	24.10.2006
TR	02	2	01	201-25		436		

Pos	Part Number	Name	Remarks	Qty	Model
39	1H0 127 401 C	fuel filter for fuel pre-heater for vehicle use with vegetable oil methyl ester -pme-		1	
40	N 021 071 5	banto bolt feed pipe	LL8 3 holes	1	ABL
41	068 130 157	banto bolt with return flow restrictor		1	ABL
42	N 013 812 8	sealing washer	A12X15,5X1,5	4	ABL
43	074 130 355	connecting piece	feed	1	AJA,AJT,AHY; automatic: ACV
(43)	074 130 355 E	connecting piece	feed	1	manual- gearbox: ACV
44	074 130 355 B	connecting piece	return	1	AJA
(44)	074 130 355 J	connecting piece	return	1	AJT, ,AHY; automatic: ACV
(44)	074 130 355 F	connecting piece	return	1	manual- gearbox: ACV
- - - E N D - - -					