



Air mass sensor for VW TDI engines

New in the aftermarket!

Vehicle	Product: air mass sensor (LMS)		
	PIERBURG No.	Replacement No.	O.E. No.*
Audi, Ford, Seat, Skoda, VW with TDI engines	7.22684.08.0	F00C 2G2 056 F00C 2G2 004	06A 906 461 028 906 461

Applications

In Otto and Diesel engines, the LMS serves the purpose of acquiring the load status of the engine. It is an important exhaust gas reduction and air supply component. In the vehicles listed on the next page, the LMS with the part number 7.22684.08.0 may be used without problems as a sensor insert for the air mass sensors (06A 906 461 and 028 906 461) used as standard with TDI engines.



Product view

Description of Operation

The principle of measurement of the hot-film anemometer has been already described in detail in PI 0020. The performance data and exhaust gas levels of the TÜV approved component

correspond to those of the series production component. Thus the operating license (ABE) of the vehicle is maintained! A corresponding component certificate is included in with each package.

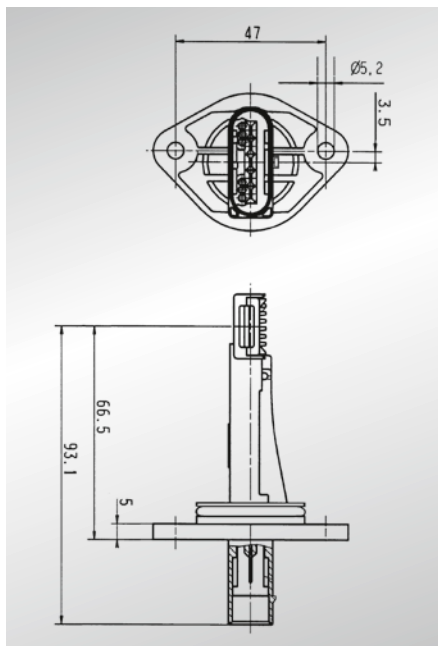

Dimensions in mm

Technical data		
Throughput range	[kg/h]	7-2.500 ¹
Temperature range	[°C]	-30 ... +130
Voltage range	[V]	8 ... 16,5
Current consumption	[mA]	<100
Output signal	[V]	0-5
Diagnosis		The zero level check, single range check

¹ Depending on the diameter of the flow cross section Product view

The right of changes and deviating pictures is reserved. Assignment and usage, refer to the each case current catalogues, TecDoc CD respectively systems based on TecDoc.

* The reference numbers given are for comparison purposes only and must not be used on invoices to the consumer.

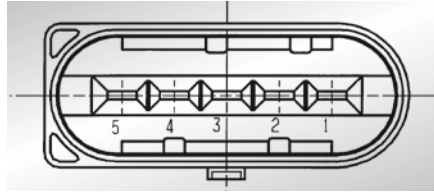
Connector view

- Pin assignment:**
- 1 TF (optional)
 - 2 Supply voltage U_{Bat}
 - 3 Ground
 - 4 Reference voltage U_{Ref}
 - 5 UA (output signal)

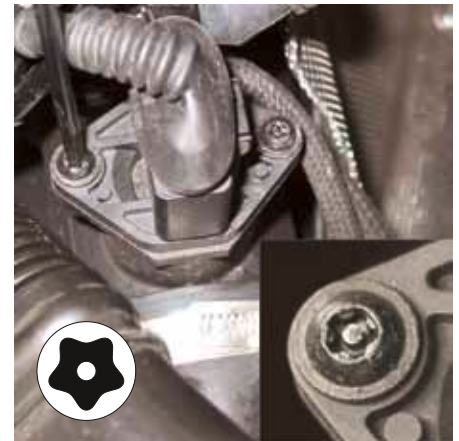

Five-star socket bolts with spigot

This rugged LMS which is insensitive to turning may be substituted against the original part without the need of introducing any changes at the connector housing.

For mounting, only the two mounting bolts (usually five star socket bolts with journal) need to be loosened and the new LMS inserted.

! While the ignition is on, no connectors may be separated or joined. The voltage peaks caused by such an action can destroy the electronic components.

Application list

Vehicle	Type	Engine type
Audi	A3, S3	AGR, ALH, ATD, AXR, AHF, ASV, ASZ, BKC
	A4, 8D	AFF, AHH, AHU, AFN, AJM, ATJ
	A4, S4	AVB, AVF, AWX
	A6, S6	AFN, AVG, AJM, AVF, AWX
Ford	Galaxy	AFN, AUY
Skoda	Fabia, Octavia (estate)	ATD, ASZ
Seat	Alhambra	ANU, AUY, AFN, ASZ
	Ibiza, Cordoba, Cordoba Vario	AFN, AGR, ALH, ASV, ASZ
	Toledo, Leon	ASZ, AGR, ALH, ASV, AHM, ARL, AFN
	Inca	ALH
VW	Polo Classic	AGR, ALH, ASV, AHU, AFN, ATD, AXR
	Golf (convertible), Jetta	AHU, AFN
	Golf, Bora	ALH, ATD, AXR, AHF, ASV, AUY, ASZ, ARL
	New Beetle (convertible)	ALH, ATD, AXR
	Caddy	ALH, AHU
	Passat (all-wheel)	AJM, AHH, AHU, AVB, AFN, ATJ, AVB, AVF, AWX
	Sharan	AUY, ASZ, AFN, ANU
	Ambulance, Transporter, Caravelle, California, Multivan	AJT
	Transporter (Synchro), Multivan, California (Coach), Ambulance (Synchro), Bus, Caravelle	ACV, AXL, AHY